

Feature		Specification	Unit
Display Spec	Brand	-	-
	Size	2.7	inch
	Resolution	320*320	dots
	Pixel Pitch	0.153(H)*0.153(V)	mm
	Display Mode	IPS/NB	-
	Viewing Direction	ALL	O'clock
	Grayscale Direction	ALL	O'clock
	Luminance	250	cd/m ²
Mechanical Characteristics	LCM(W*H*D)	53.50*60.00*2.30	mm
	Active Area(W*H)	48.96*48.96	mm
	With/Without TP	Without TP	-
	LED Numbers	3S2P-LED	pcs
	Operation Temp.	-20~+70	°C
	Storage Temp.	-30~+80	°C
Electrical Characteristics	Interface	16bit RGB/39PIN	-
	LCM Power Supply	2.8	v
	LED Power Supply	3.0	v
	Color Depth	262K	-
	LCM Driver IC	ILI9488	-
	CTP Driver IC	-	-

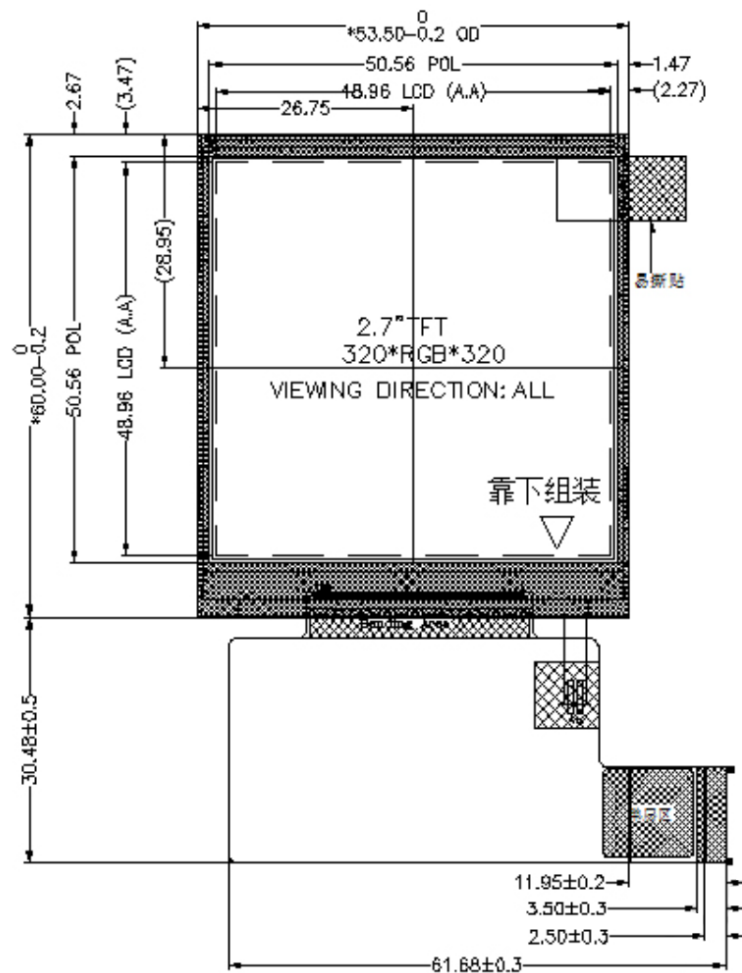

PIN FUCTION	
1	IDVCC
2	SCL
3	SDA
4	/CS
5	RESET
6	ENABLE
7	GND
8	DOTCLK
9	GND
10	HSYNC
11	VSYNC
12	GND
13	R4
14	R3
15	R2
16	R1
17	R0
18	GND
19	G5
20	G4
21	G3
22	G2
23	G1
24	G0
25	GND
26	B4
27	B3
28	B2
29	B1
30	B0
31	NC
32	LEDA
33	LEDK
34	GND
35	VCC
36	GND
37	GND
38	GND
39	GND